

符合RoHS

ERON®

STAINLESS ADJUSTABLE HEEL PINS

No.E-9986

## 可调支撑螺钉(SUS)

材质 SUS316

附件 六角螺母1个

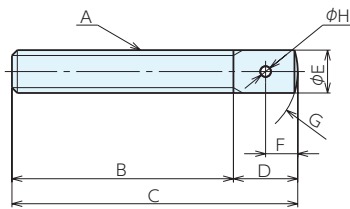

## 规格

订单号	型号	A (粗牙)	B	C	D	E	F	G	H	重量g
938935	HS0630S	M 6×1.0	22	30	8	6	5	R 6	2	6
938936	HS0640S	M 6×1.0	32	40	8	6	5	R 6	2	8
938937	HS0650S	M 6×1.0	42	50	8	6	5	R 6	2	10
938938	HS0840S	M 8×1.25	28	40	12	8	6	R10	3	13
938939	HS0850S	M 8×1.25	38	50	12	8	6	R10	3	16
938940	HS0860S	M 8×1.25	48	60	12	8	6	R10	3	20
938942	HS1060S	M10×1.5	44	60	16	10	8	R16	3	30
938943	HS1070S	M10×1.5	54	70	16	10	8	R16	3	40
938944	HS1260S	M12×1.75	42	60	18	12	9	R20	3	45
938945	HS1280S	M12×1.75	62	80	18	12	9	R20	3	60

## 使用例

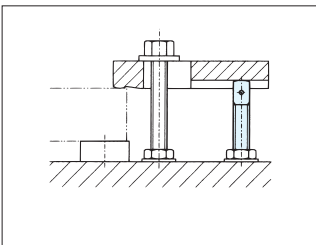

基准台面

辅助台面

精密平口钳

夹具单元

夹持工装零部件

定位元件

装入式零件

隔振及防振

千斤顶

平台、测量仪

钻床平口钳

机工虎钳

索引