



SCS-FB



SCS-GB

符合RoHS

NBK®

No.E-9531

CLAMPING SCREWS

## 夹紧定位用螺钉

**材质** 本体：SCM435 球体：SUJ2

**热处理** 球体：淬火HRC56~60

**表面处理** 本体：发黑处理 球体（SCS-FB）：发黑处理

- 可根据情况最大旋转9°。在倾斜面上也可牢靠夹紧。
- 带防反转机构，可始终以球体的平面部牢靠夹紧。
- SCS-GB对于铸造面等粗糙表面也可牢靠夹紧。

SCS-FB

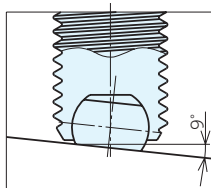
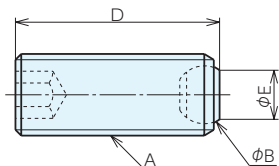
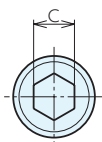

SCS-GB

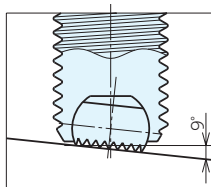
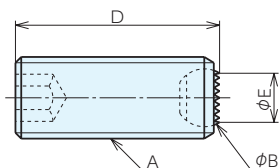
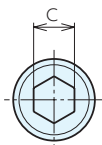

### 规格

通用尺寸						SCS-FB		SCS-GB	
A (粗牙)	B	C	D	E	重量g	订单号	型号	订单号	型号
M 6×1.0	4	3	10	3.2	1.5	932796	SCS-M 6-10-FB	932841	SCS-M 6-10-GB
M 6×1.0	4	3	16	3.2	2.5	932797	SCS-M 6-16-FB	932842	SCS-M 6-16-GB
M 6×1.0	4	3	20	3.2	3.4	932798	SCS-M 6-20-FB	932843	SCS-M 6-20-GB
M 6×1.0	4	3	25	3.2	4	932799	SCS-M 6-25-FB	932844	SCS-M 6-25-GB
M 8×1.25	5.5	4	10	4.5	2.5	932800	SCS-M 8-10-FB	932845	SCS-M 8-10-GB
M 8×1.25	5.5	4	12	4.5	3.2	932801	SCS-M 8-12-FB	932846	SCS-M 8-12-GB
M 8×1.25	5.5	4	20	4.5	5.7	932802	SCS-M 8-20-FB	932847	SCS-M 8-20-GB
M 8×1.25	5.5	4	25	4.5	7.7	932803	SCS-M 8-25-FB	932848	SCS-M 8-25-GB
M 8×1.25	5.5	4	30	4.5	9	932804	SCS-M 8-30-FB	932849	SCS-M 8-30-GB
M10×1.5	7	5	12	6	5	932805	SCS-M10-12-FB	932850	SCS-M10-12-GB
M10×1.5	7	5	16	6	7	932806	SCS-M10-16-FB	932851	SCS-M10-16-GB
M10×1.5	7	5	20	6	9.5	932807	SCS-M10-20-FB	932852	SCS-M10-20-GB
M10×1.5	7	5	25	6	11	932808	SCS-M10-25-FB	932853	SCS-M10-25-GB
M10×1.5	7	5	35	6	16	932809	SCS-M10-35-FB	932854	SCS-M10-35-GB
M12×1.75	8.5	6	16	7.2	10	932810	SCS-M12-16-FB	932855	SCS-M12-16-GB
M12×1.75	8.5	6	20	7.2	12.5	932811	SCS-M12-20-FB	932856	SCS-M12-20-GB
M12×1.75	8.5	6	30	7.2	20	932812	SCS-M12-30-FB	932857	SCS-M12-30-GB
M12×1.75	8.5	6	40	7.2	28	932813	SCS-M12-40-FB	932858	SCS-M12-40-GB
M16×2	12	8	20	10.7	22	932814	SCS-M16-20-FB	932859	SCS-M16-20-GB
M16×2	12	8	25	10.7	28	932815	SCS-M16-25-FB	932860	SCS-M16-25-GB
M16×2	12	8	35	10.7	41	932816	SCS-M16-35-FB	932861	SCS-M16-35-GB
M16×2	12	8	50	10.7	48	932817	SCS-M16-50-FB	932862	SCS-M16-50-GB

基准台面

辅助台面

精密平口钳

夹具单元

夹持工装零部件

定位元件

装入式零件

隔振及防振

千斤顶

平台、测量仪

钻床平口钳

机工虎钳

索引